

EGLE

MICHIGAN DEPARTMENT OF ENVIRONMENT, GREAT LAKES, AND ENERGY
WATER RESOURCES DIVISION

CHEMICAL TABLE TEMPLATE FOR TREATMENT OF NUISANCE AQUATIC PLANT AND/OR ALGAE GROWTH

Completion of the chemical table template is required by multiple reports in MiWaters. Once complete, upload a copy to the space provided in the associated MiWaters form. Do not alter this template, with the exception of adding additional treatment dates.

ANC Treatment Report:

Upload this chemical table template to the MiWaters treatment report form **no later than November 30**.

ANC Expansion Report:

Upload this chemical table template to the MiWaters expansion report form **within 15 business days after the initial treatment of the expanded area of impact**.

ANC Interim Treatment Report:

Upload this chemical table template to the MiWaters interim treatment report form upon request from EGLE.

Permit Number:

ANC9806504

Permittee Name:

PLM Lake and Land Management

Body of Water Treated:

WB-2804-1 Miramichi

County:

Mecosta County Osceola County

Date of treatment (one per section):

5/19/2022

Name of person applying chemical:

Salvatore Adams

Name of Company or NA if not applicable:

PLM Lake and Land Management

Effectiveness:

☒

Good (70-100%)

☐

Fair (50-69%)

☐

Poor (Less than 50%)

☐

Ineffective (0%)

Chemical Brand Used	EPA Registration Number	Method of Application	Application Rate (10 lbs./acre, etc.)	Treatment Area Size: (Acres)	Average Depth (Feet)	Total Amount (4 gallons, 10 lbs., etc.)	For Control of: (Plant and/or Algae names)
Captain	67690-9	Surface Application/Injection	.6 Gals/Acre Ft	4 Acres	3 Ft	7.2 Gallon	Filamentous Algae

Date of treatment (one per section): 6/1/2022

Name of person applying chemical: Salvatore Adams

Name of Company or NA if not applicable: PLM Lake and Land Management

Effectiveness: ☒ Good (70-100%) ☐ Fair (50-69%) ☐ Poor (Less than 50%) ☐ Ineffective (0%)

Chemical Brand Used	EPA Registration Number	Method of Application	Application Rate (10 lbs./acre, etc.)	Treatment Area Size: (Acres)	Average Depth (Feet)	Total Amount (4 gallons, 10 lbs., etc.)	For Control of: (Plant and/or Algae names)
Captain XTR	67690-9	Surface Application/Injection	.6 Gals/Acre Ft	12.5 Acres	3 Ft	22.5 Gallon	Filamentous Algae
Cygnat Plus	Cygnat Plus	Surface Application/Injection	.084 Gals/Acre Ft	40 Acres	3 Ft	10 Gallon	Adjuvant
Propeller	81927-68	Surface Application/Injection	.67 Lbs/Acre Ft	5 Acres	3 Ft	10 Pound	LLPW
Tribune	100-1390	Surface Application/Injection	1 Gall/Acre	35 Acres	3 Ft	35 Gallons	CLP LLPW

Date of treatment (one per section): 6/22/2022

Name of person applying chemical: BreAnne Grabill

Name of Company or NA if not applicable: PLM Lake and Land Management

Effectiveness: ☒ Good (70-100%) ☐ Fair (50-69%) ☐ Poor (Less than 50%) ☐ Ineffective (0%)

Chemical Brand Used	EPA Registration Number	Method of Application	Application Rate (10 lbs./acre, etc.)	Treatment Area Size: (Acres)	Average Depth (Feet)	Total Amount (4 gallons, 10 lbs., etc.)	For Control of: (Plant and/or Algae names)
Aqua Strike	70506-302	Surface Application/Injection	.84 Gals/Acre Ft	5.6 Acres	3 Ft	14 Gallon	LLPW
Cygnat Plus	Cygnat Plus	Surface Application/Injection	.11 Gals/Acre Ft	6.6 Acres	3 Ft	2 Gallon	Adjuvant
Propeller	81927-68	Surface Application/Injection	.5 Lbs/Acre Ft	5.6 Acres	3 Ft	8.4 Pounds	LLPW
		Surface Application/Injection	.87 Lbs/Acre Ft	1 Acre	3 Ft	2.6 Pounds	LLPW

Date of treatment (one per section): 6/28/2022

Name of person applying chemical: Garrett Johnson

Name of Company or NA if not applicable: PLM Lake and Land Management

Effectiveness: ☒ Good (70-100%) ☐ Fair (50-69%) ☐ Poor (Less than 50%) ☐ Ineffective (0%)

Chemical Brand Used	EPA Registration Number	Method of Application	Application Rate (10 lbs./acre, etc.)	Treatment Area Size: (Acres)	Average Depth (Feet)	Total Amount (4 gallons, 10 lbs., etc.)	For Control of: (Plant and/or Algae names)
Captain	67690-9	Surface Application/Injection	.097 Gals/Acre Ft	17.2 Acres	3 Ft	5 Gallon	Filamentous Algae
Copper Chara (Old Bridge)	46923-4	Surface Application/Injection	1.94 Lbs/Acre Ft	17.2 Acres	3 Ft	100 Pounds	Filamentous Algae
		Surface Application/Injection	3.67 Lbs/Acre Ft	5 Acres	3 Ft	56 Pounds	Chara

Date of treatment (one per section): 7/28/2022

Name of person applying chemical: Dustin Grabill

Name of Company or NA if not applicable: PLM Lake and Land Management

Effectiveness: ☒ Good (70-100%) ☐ Fair (50-69%) ☐ Poor (Less than 50%) ☐ Ineffective (0%)

Chemical Brand Used	EPA Registration Number	Method of Application	Application Rate (10 lbs./acre, etc.)	Treatment Area Size: (Acres)	Average Depth (Feet)	Total Amount (4 gallons, 10 lbs., etc.)	For Control of: (Plant and/or Algae names)
Aqua Strike	70506-302	Surface Application/Injection	.84 Gals/Acre Ft	2 Acres	3 Ft	5 Gallon	LLPW
Copper (Old Bridge)	46923-4	Surface Application/Injection	1.94 Lbs/Acre Ft	12.75 Acres	3 Ft	74 Pound	Filamentous Algae
Cygnat Plus	Cygnat Plus	Surface Application/Injection	.084 Gals/Acre Ft	2 Acres	3 Ft	0.5 Gallon	Adjuvant
Propeller	81927-68	Surface Application/Injection	.5 Lbs/Acre Ft	2 Acres	3 Ft	3 Pound	LLPW
SecClear G	67690-72	Surface Application/Injection	.92 Lbs/Acre Ft	12.75 Acres	3 Ft	35 Pound	Filamentous Algae

Date of treatment (one per section): 9/2/2022

Name of person applying chemical: Salvatore Adams

Name of Company or NA if not applicable: PLM Lake and Land Management

Effectiveness: ☒ Good (70-100%) ☐ Fair (50-69%) ☐ Poor (Less than 50%) ☐ Ineffective (0%)

Chemical Brand Used	EPA Registration Number	Method of Application	Application Rate (10 lbs./acre, etc.)	Treatment Area Size: (Acres)	Average Depth (Feet)	Total Amount (4 gallons, 10 lbs., etc.)	For Control of: (Plant and/or Algae names)
Captain	67690-9	Surface Application/Injection	.097 Gals/Acre Ft	17.24 Acres	3 Ft	5 Gallon	Planktonic Algae
Copper Chara (Old Bridge)	46923-4	Surface Application/Injection	1.94 Lbs/Acre Ft	17.24 Acres	3 Ft	100 Pound	Planktonic Algae

If you need this information in an alternate format, contact EGLE-Accessibility@Michigan.gov or call 800-662-9278.

EGLE does not discriminate on the basis of race, sex, religion, age, national origin, color, marital status, disability, political beliefs, height, weight, genetic information, or sexual orientation in the administration of any of its programs or activities, and prohibits intimidation and retaliation, as required by applicable laws and regulations. Questions or concerns should be directed to the Nondiscrimination Compliance Coordinator at EGLE-NondiscriminationCC@Michigan.gov or 517-249-0906.

This form and its contents are subject to the Freedom of Information Act and may be released to the public.

Lower Miramichi
201 Surface Acres
Osceola County
Evert Township
T17N R8W Sec 33, 32

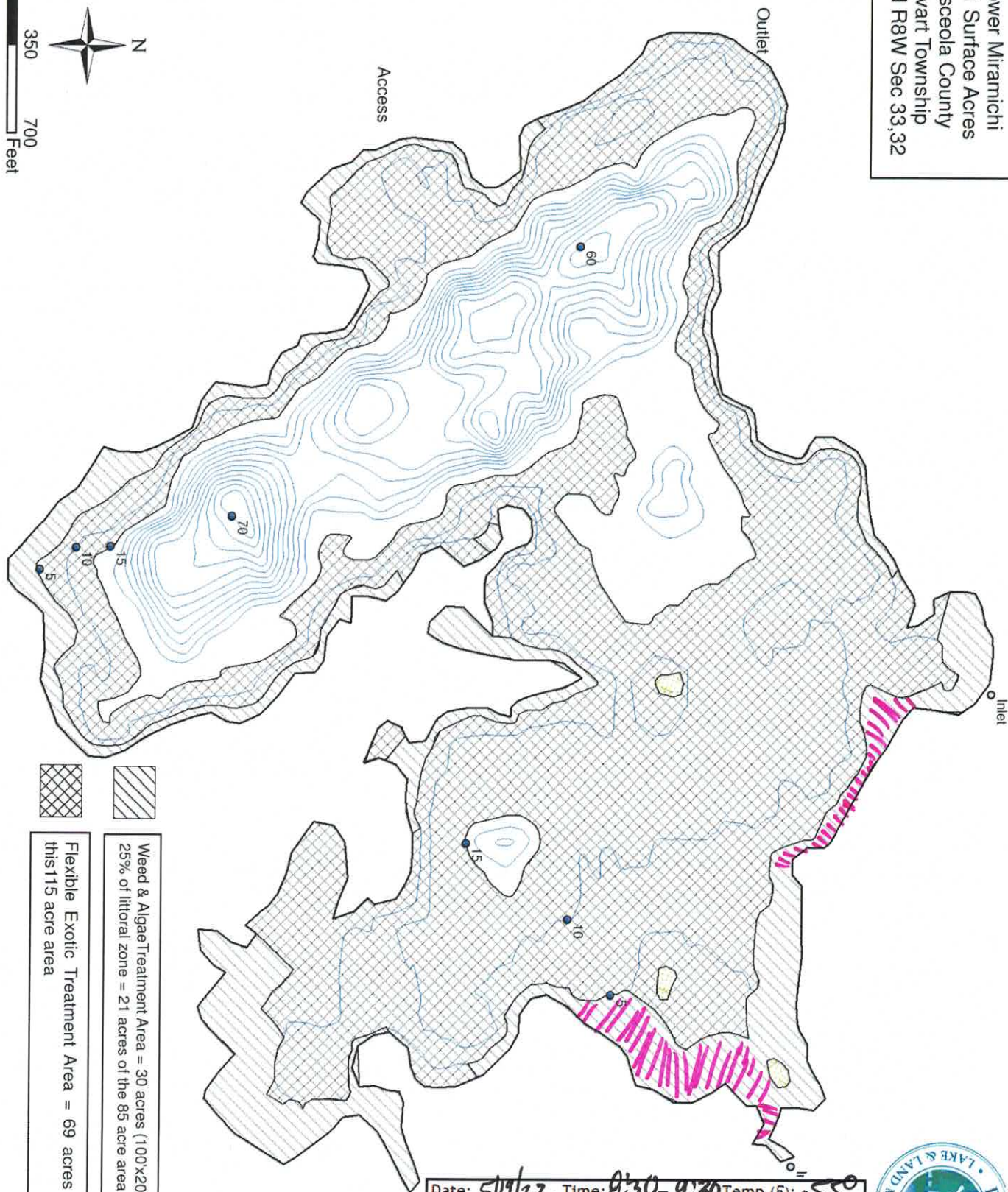
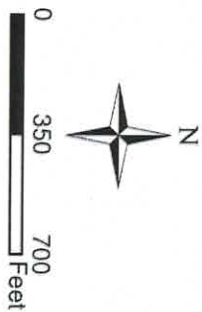

 Weed & Algae Treatment Area = 30 acres (100'x200')
 25% of littoral zone = 21 acres of the 85 acre area

 Flexible Exotic Treatment Area = 69 acres within
 this 115 acre area

Date: 5/19/12 Time: 8:30-9:30 Temp (F): 55°
 Sun PC Cloudy Rain Wind (mph): 0-3 5-10 10+
 Outlet is flowing: Y or N Applicator: SA
☐ 100' rule/resident ☒ active spawning isolation
 (20' rule/copper products)



 Fil. Algae w/ Captain C. Log/Ae (7-29)
 4 Acres

Lower Miramichi
201 Surface Acres
Osceola County
Ewart Township
T17N R8W Sec 33,32



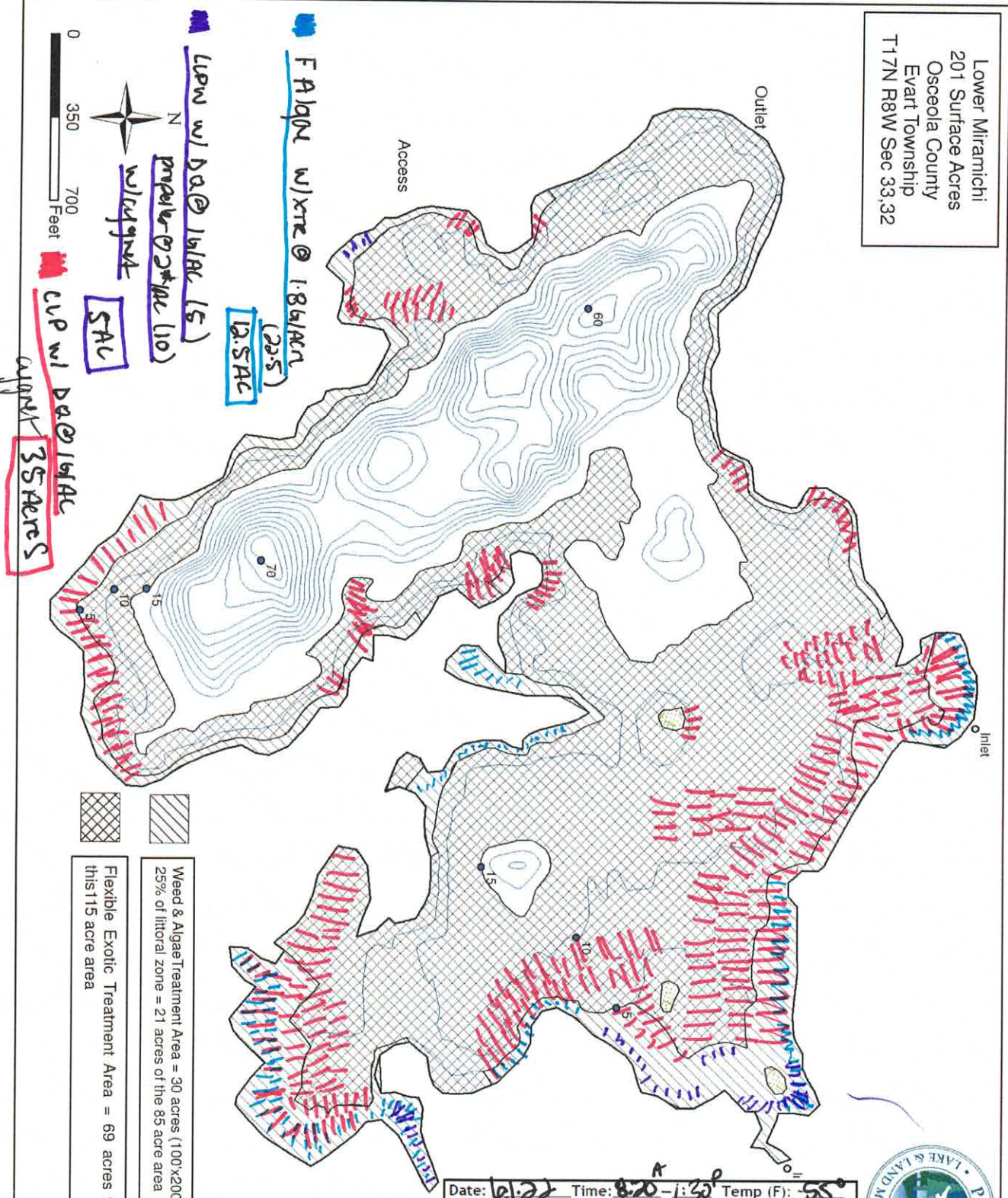

Date: 6/1/22 Time: 8:20 A - 1:30 P Temp (F): 55°
 Sun: PC Cloudy Rain Wind (mph): 0-5 5-10 10+
 Outlet is flowing: Y or N Applicator: Salvatore
☒ 100' rule/resident ☒ Active spawning isolation
 (20' rule/copper products)



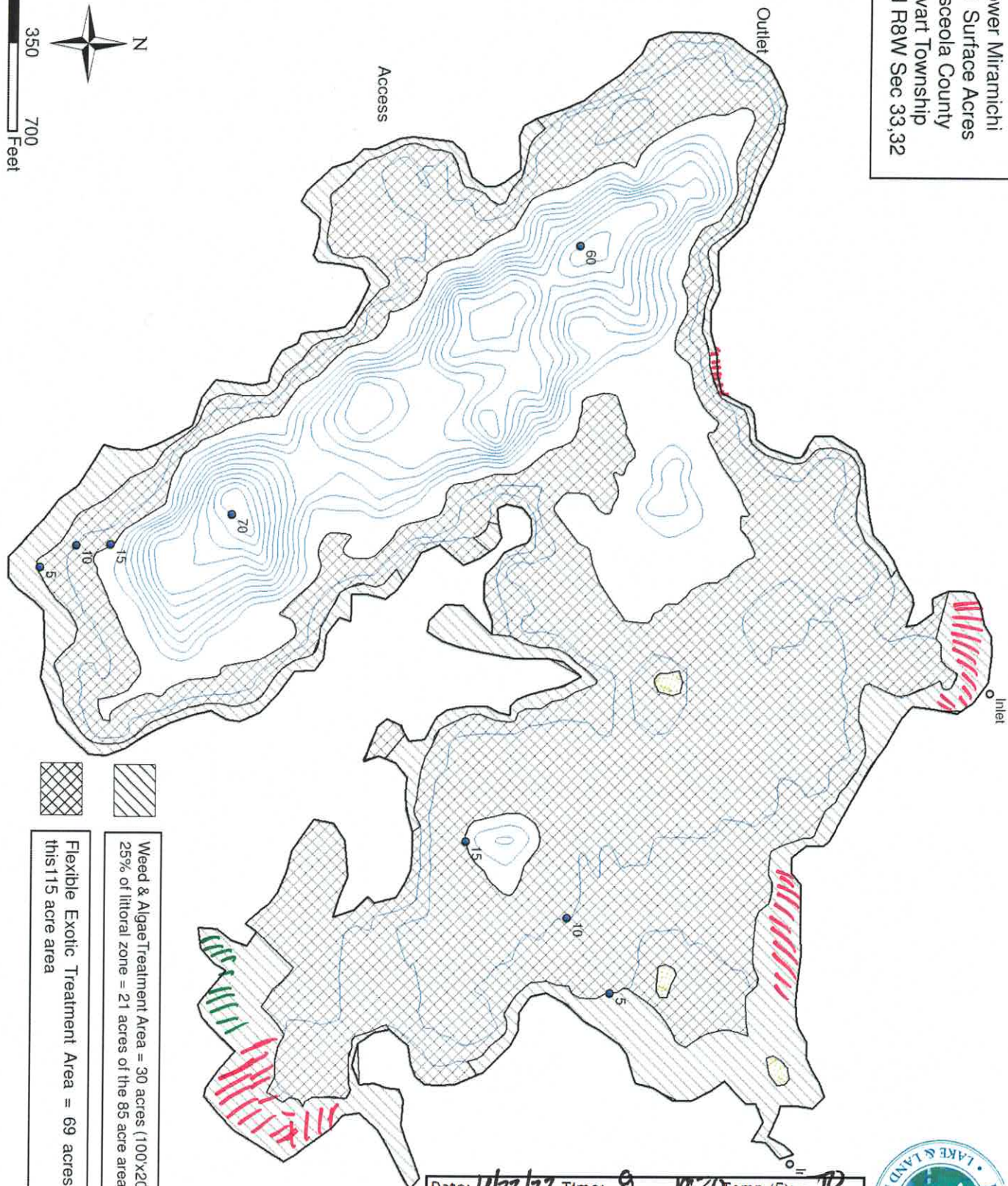
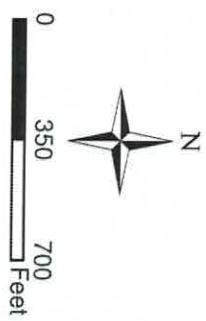

Lower Miramichi
201 Surface Acres
Osceola County
Evert Township
T17N R8W Sec 33.32

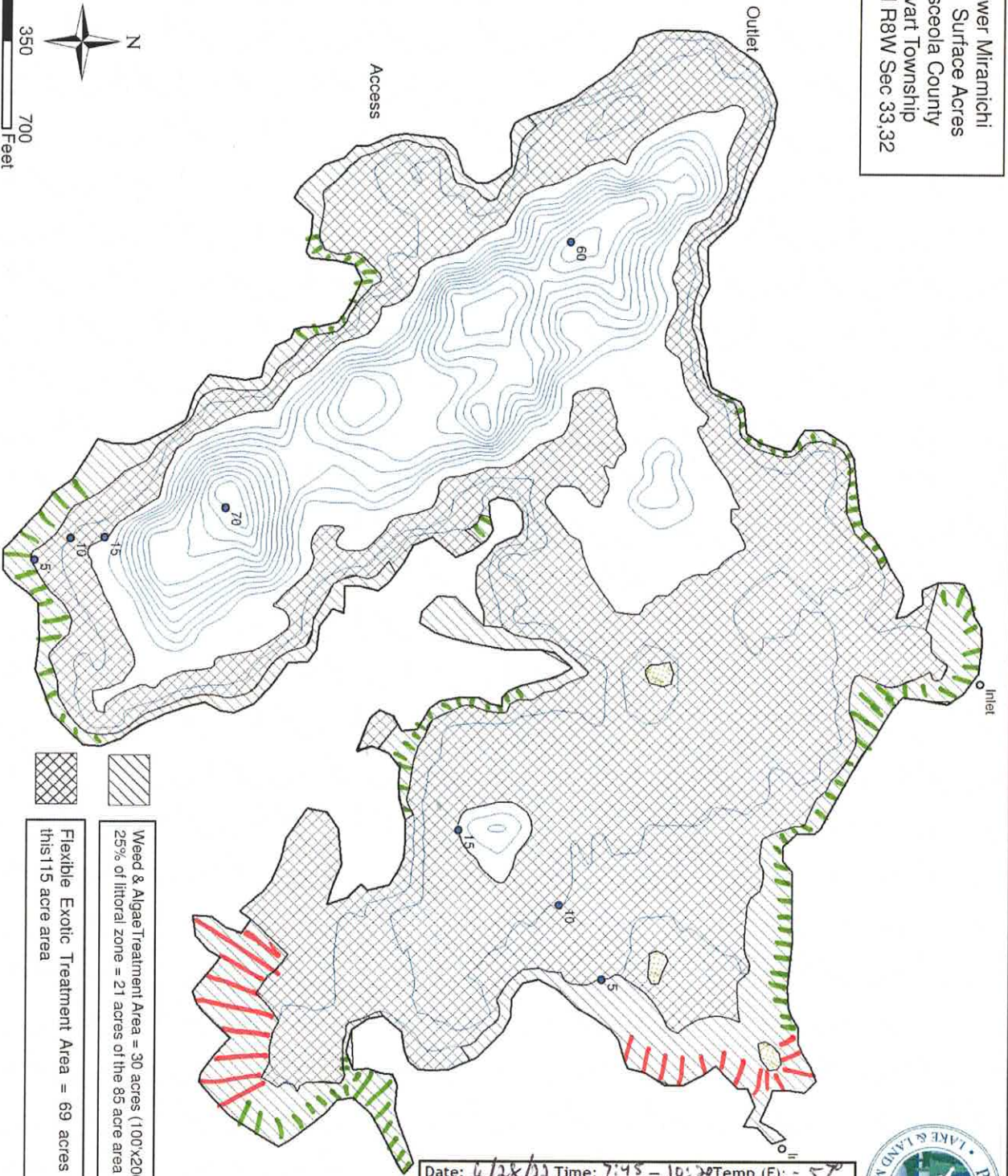
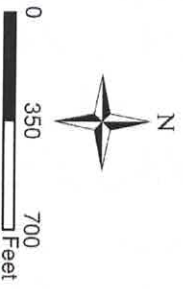

 LLPW w/ Flumi's 2.6 H/Ac w/ Cygnus 1A
 LLPW, VLPW, Nalad, B. Cygnus Strike 2.59 H/Ac w/ Flumi's 1.5 H/Ac w/ Cygnus 5.6 A

Lower Miranichi
201 Surface Acres
Osceola County
Evert Township
T17N R8W Sec 33,32



 Weed & Algae Treatment Area = 30 acres (100'x200')
25% of littoral zone = 21 acres of the 85 acre area

 Flexible Exotic Treatment Area = 69 acres within this 115 acre area

Date: 6/28/11 Time: 7:45 - 10:30 Temp (F): - 57
Sun PC Cloudy Rain Wind (mph): 0-5 5-10 10+
Outlet is flowing W or N Applicator: Garrett
☒ 100' rule/resident ☒ active spawning isolation
(20' rule/copper products)



Chaca w/cosy @ 11 lbs/AC
5 AC = 55 lbs

F. Algae w/cosy @ 5.8 lbs/AC
w/captain @ 0.29 gal/AC
17.2 AC = 160 lbs
17.2 AC = 5 gal

Lower Miramichi
201 Surface Acres
Osceola County
Evert Township
T17N R8W Sec 33,32

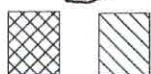
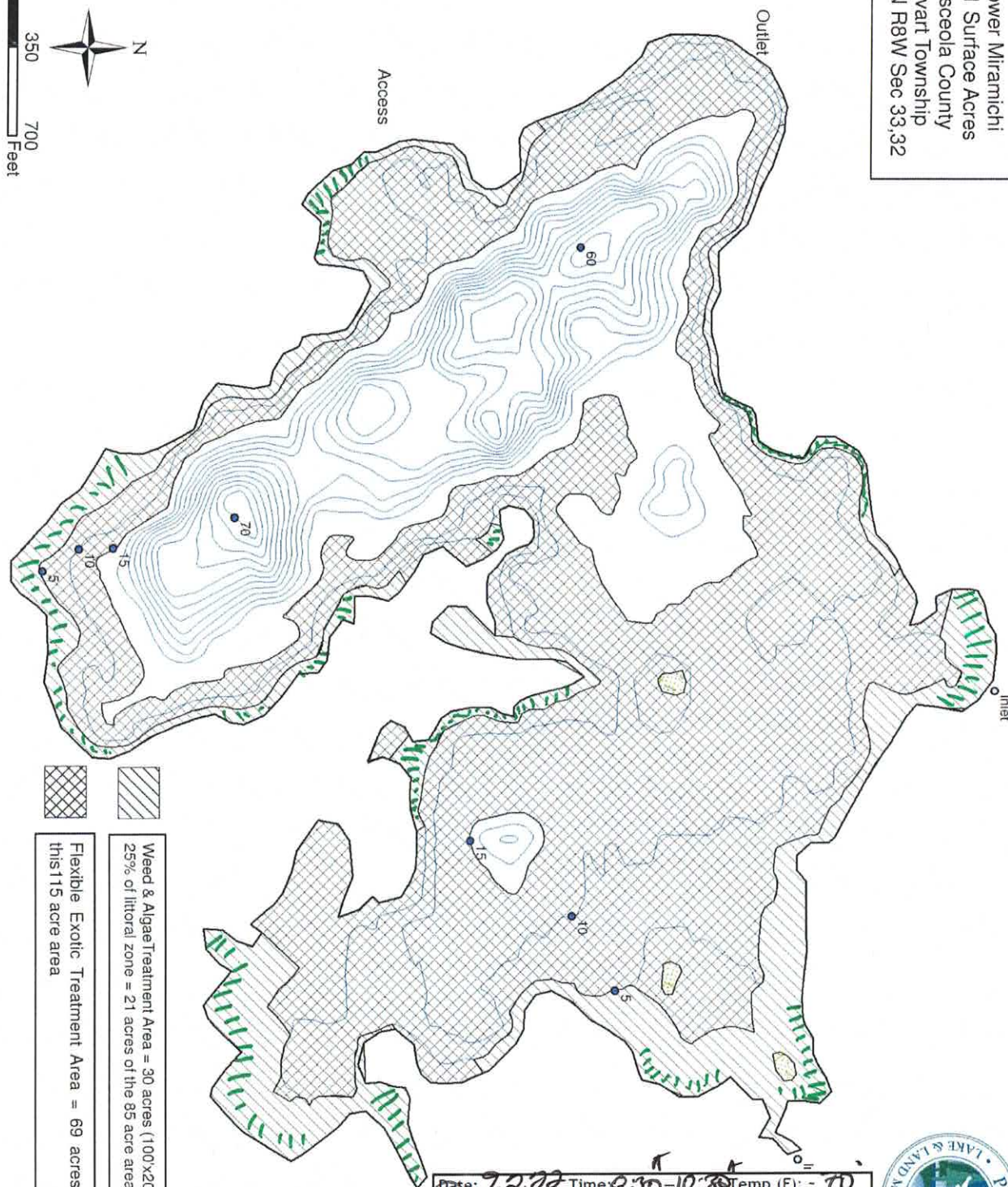
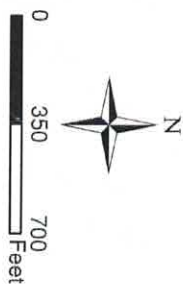

Weed & Algae Treatment Area = 30 acres (100'x200')
25% of littoral zone = 21 acres of the 85 acre area

Flexible Exotic Treatment Area = 69 acres within
this 115 acre area

Date: 7.2.22 Time: 8:30-10:30 Temp (F): - 70
Sun PC Cloudy Rain Wind (mph) 0-5 5-10 10+
Outlet is flowing: Y or N ☒ Y Applicator: Salvatore
☒ 100' rule/resident ☒ Active spawning isolation
(20' rule/copper products)



PAIgal w/ CUSOYCS 8th Acre (100th)
Captain @ .29 GAL (56)

17.24 Acres